

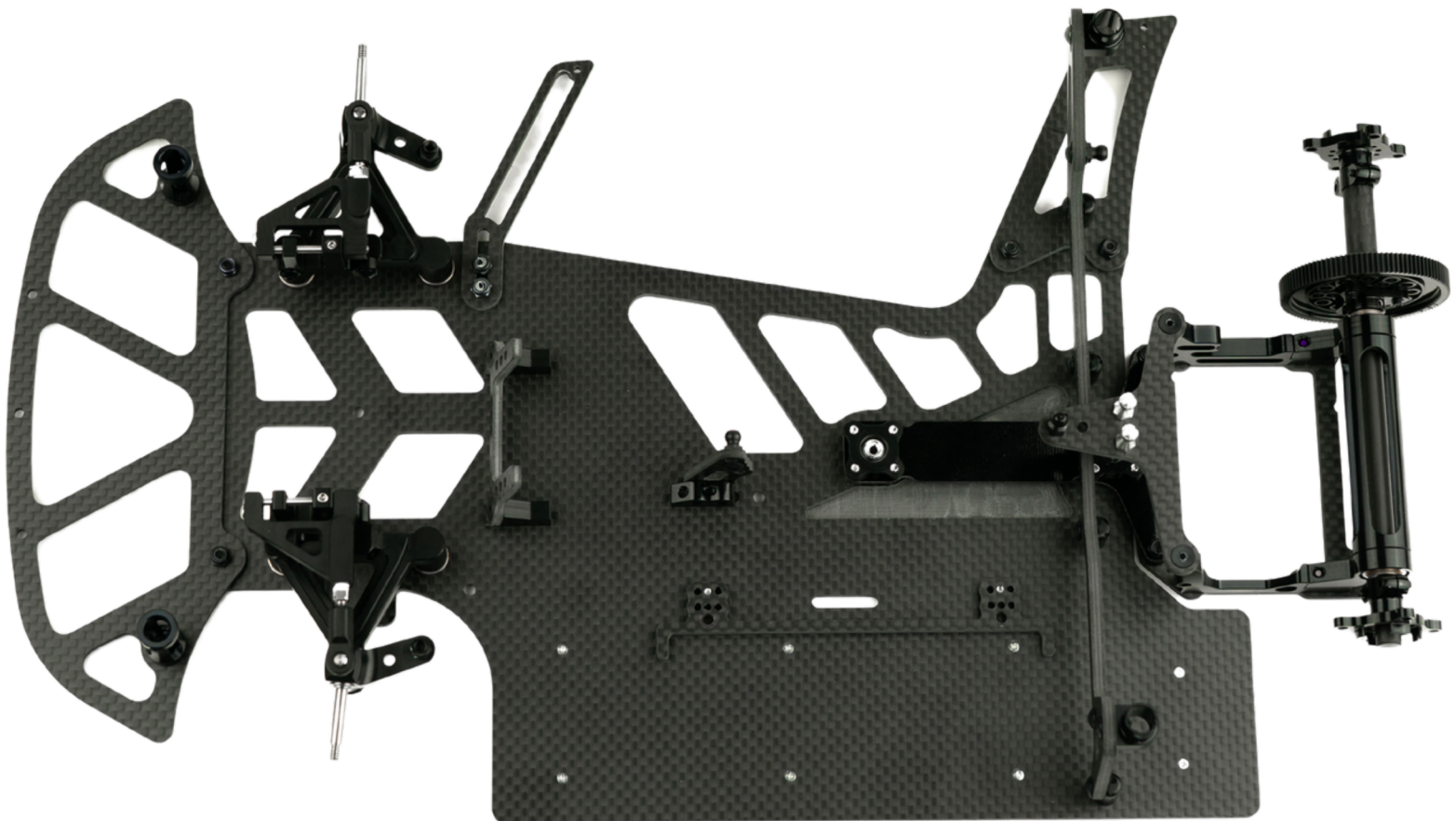

*2025 Resurgent
Assembly Instructions*



Conversion kit contains 4 separate parts bags



T Plate Assembly

Qty1 Black Fiberglass T Plate

Qty 2 T Plate Pivots

Qty 8 2/56 x 3/16 Button Head Screws

Qty 2 4/40 x 3/8 Flat Head Socket Screws

Qty 2 4/40 x 3/16 Hex Locknuts

Qty 2 2 mm shim



Rear Pod

Carbon Bottom Plate

Carbon Top Plate

QTY 2 Axle Tube Mounts

Axle Tube

Motor Plate

Sensor Plate

Shim Set (1.0, 1.25, 1.50, 1.75, 2.0)

Qty 2 4-40 x 1/4" FH

Qty 4 4-40 x 1/2" FH Titanium



Carbon

2025 Resurgent Chassis plate

Battery Locator

Resurgent Shock Tower/Cross Brace

Center Shock Mount

Rear Resurgent Nerf Bar

Front Resurgent Nerf Bar



Screws/Etc.

4-40 x 1/4 Flat Head Socket Screws
4-40 x 5/16 Flat Head Socket Screws
4-40 x 1/4 Button Head Socket Screws
4-40 x 3/16 Button Head Socket Screws
Short Set Screws
2-56 x 3/16 Flat Head Socket Screws
4-40 x 3/16 Hex Locknuts
Short Ball Studs
Medium Ball Stud
Medium IRS-355 ball studs
Cross Brace Stand Offs
Rear Body Mounts
Center Shock Base

Screw Chart

4-40 x 5/16" FH

4-40 x 3/8" FH

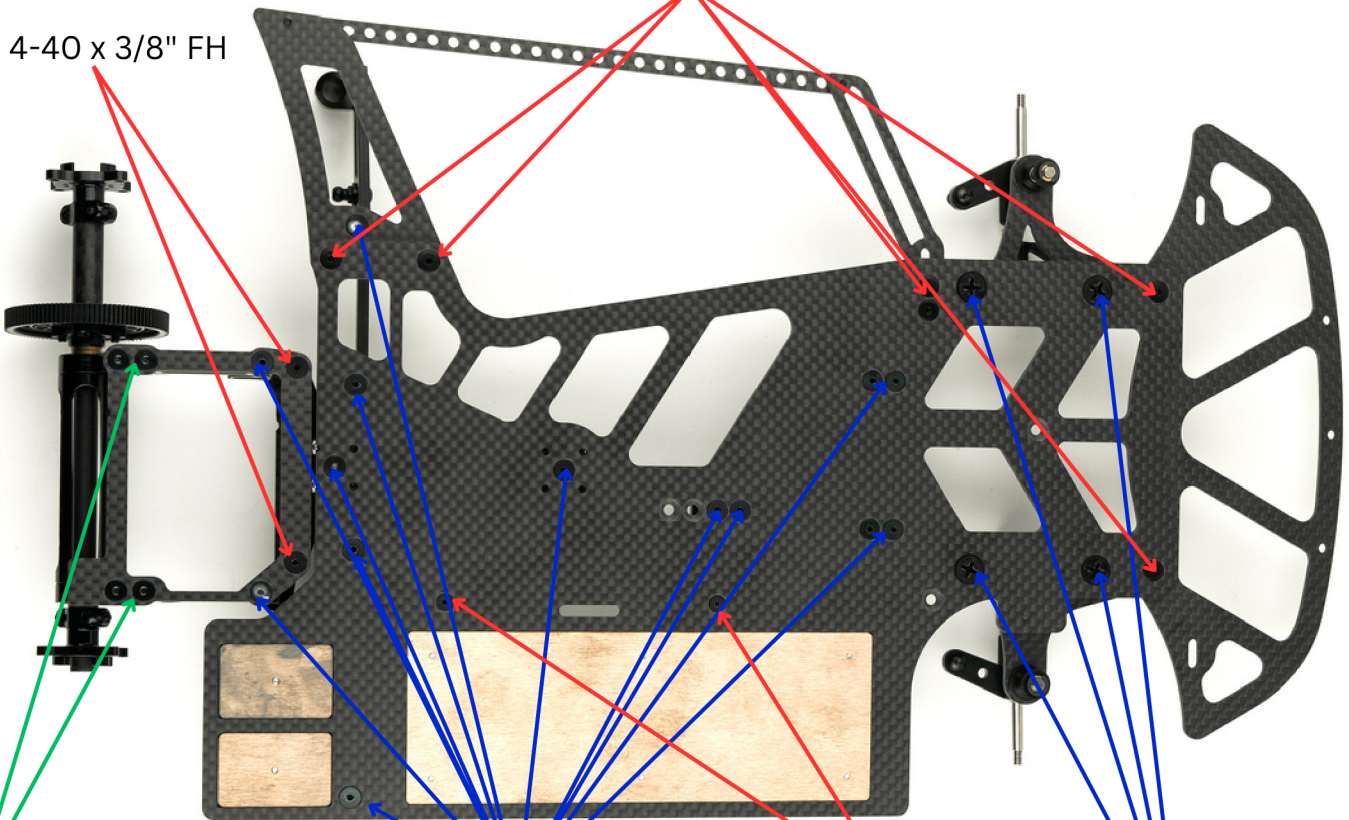

4-40 x 1/2" FH
Titanium

4-40 x 1/4" FH

2-56 x 3/16" FH

8-32 x 1/2" FH

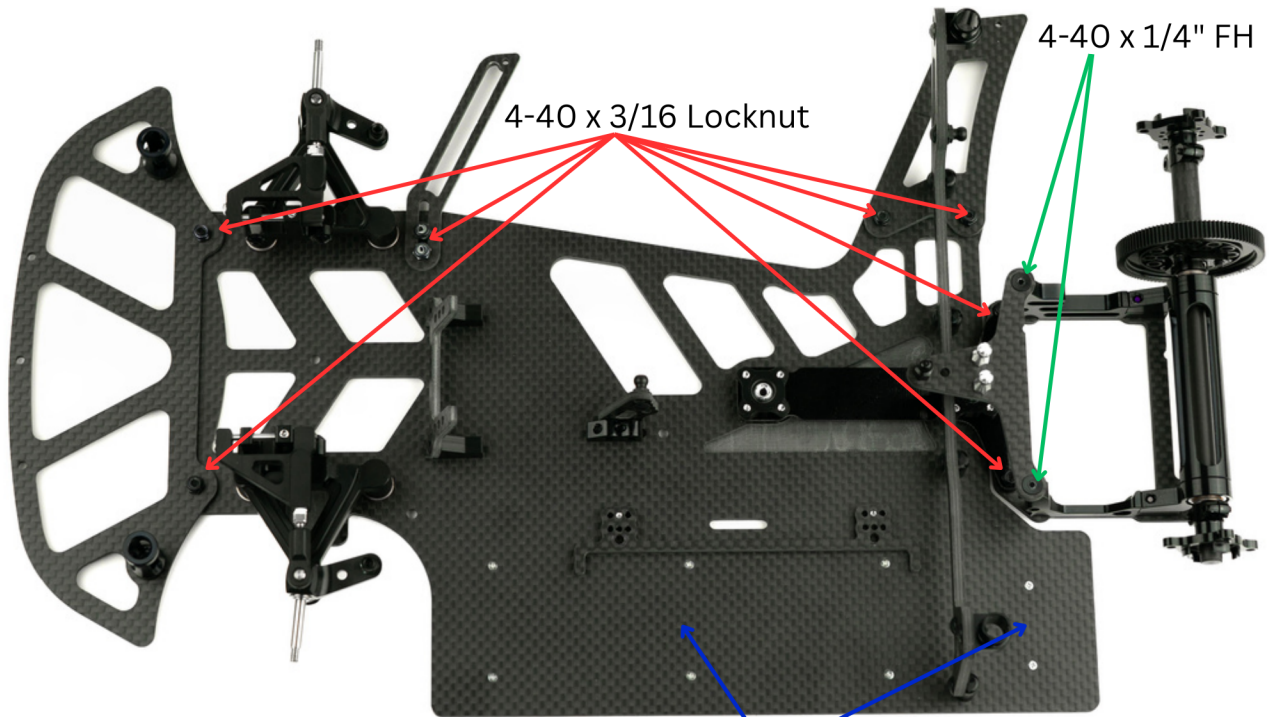

4-40 x 3/16 Locknut

4-40 x 1/4" FH

Weights M1.7 FH

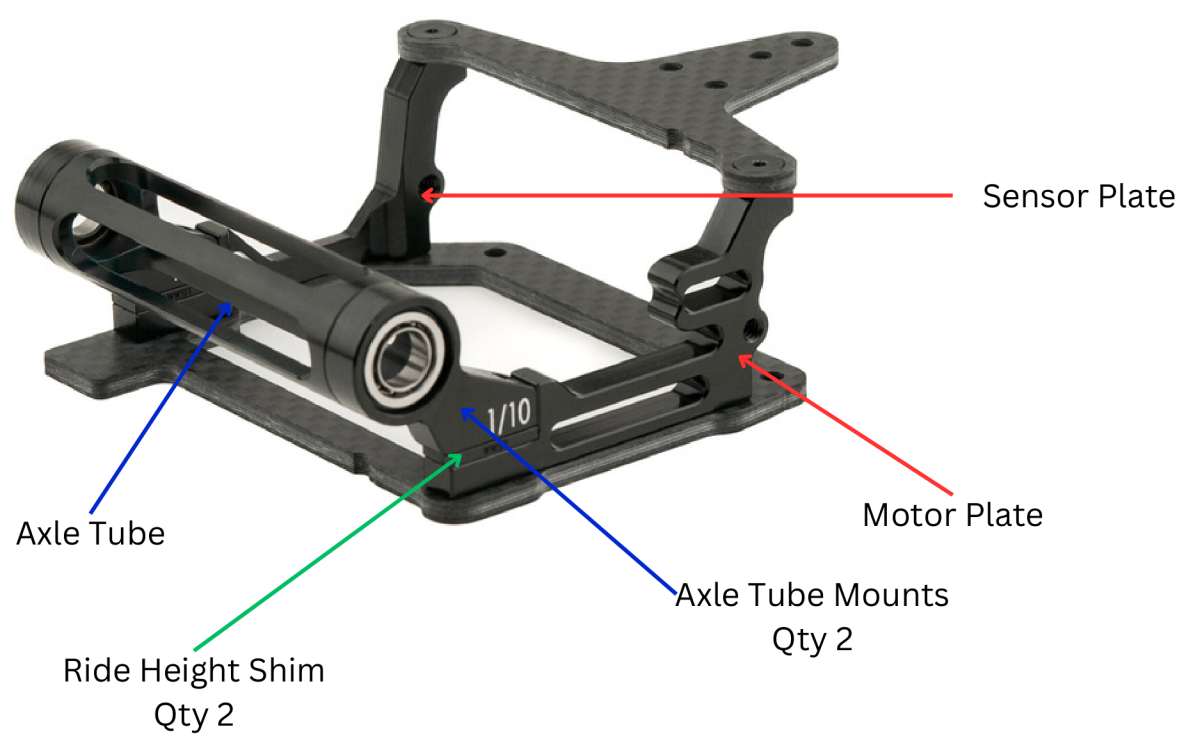
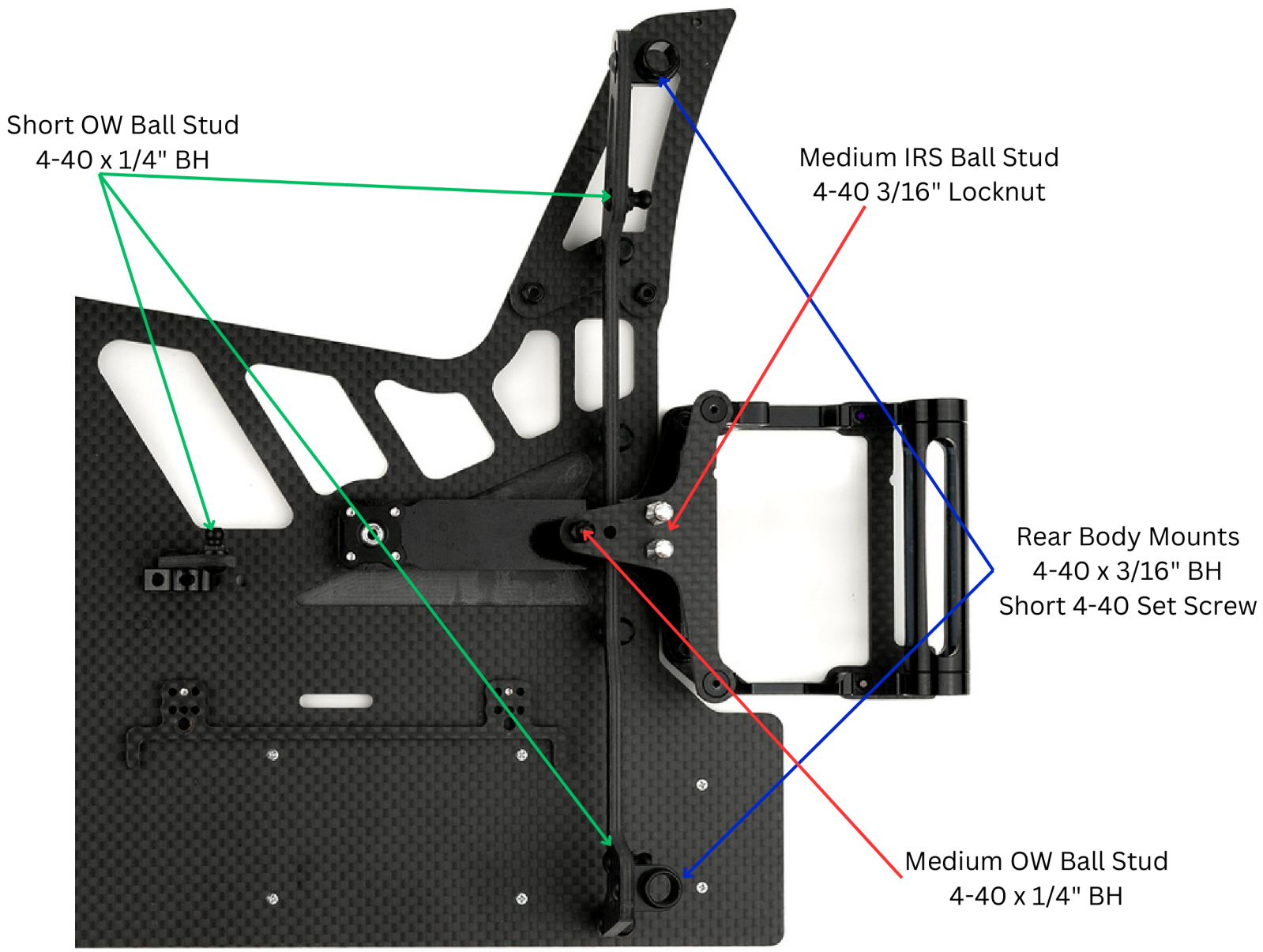

Rear Pod / T Plate / Rear Axle

Machined T-Plate Pivots

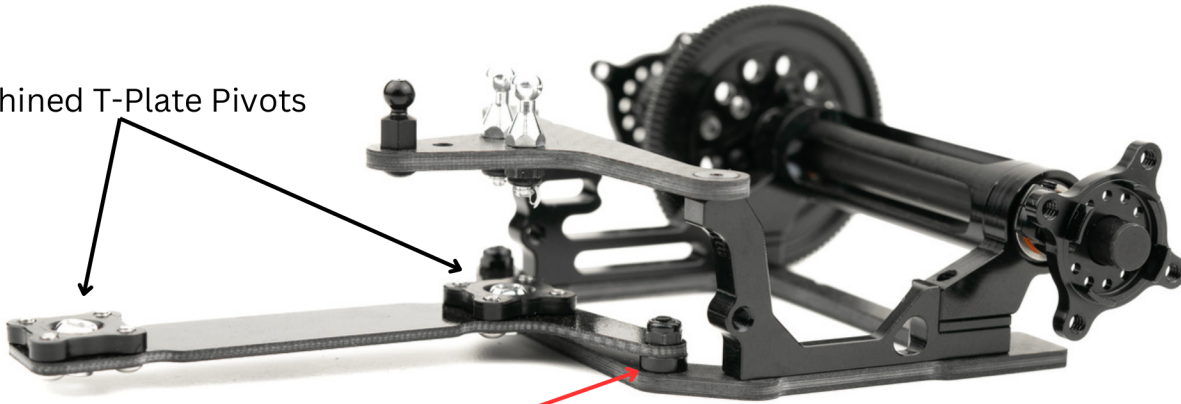

Pod / T Plate Shim

Use 2mm (0.080") for Fiberglass T Plate

Use 2.5mm (0.100") For Steel T Plate

Rear Axle Shims
Start with 0.120" Right and
0.08" Left, then adjust as needed

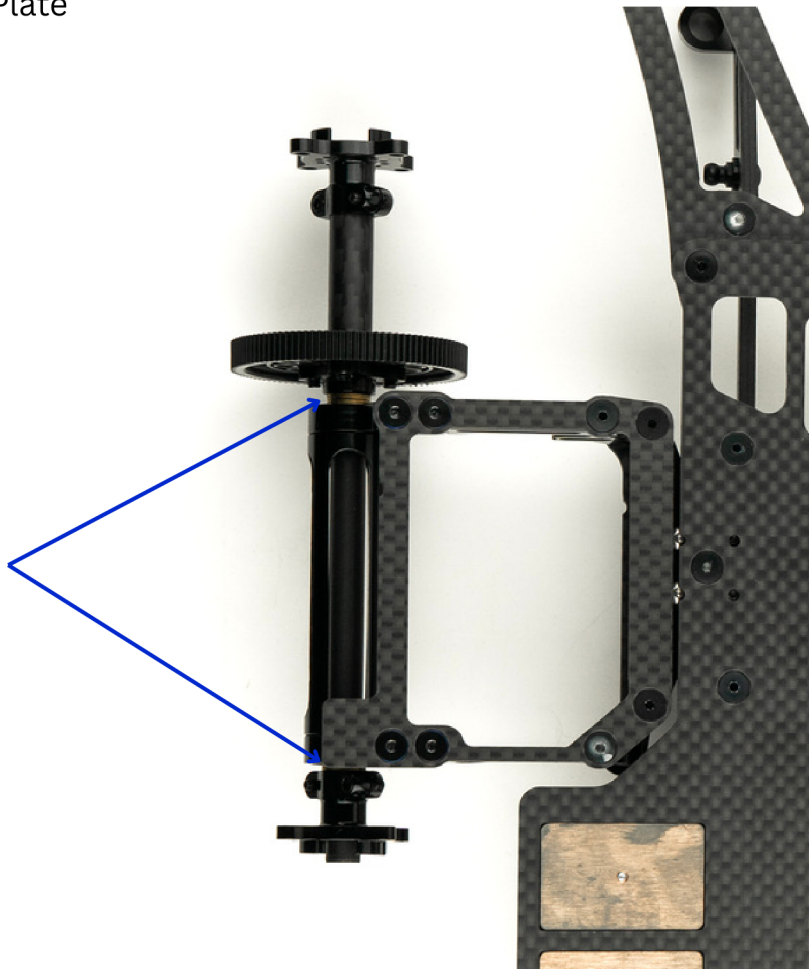

Shock Assembly

VCS MICRO SHOCK

Team Associated's VCS™ (Volume Compensating System) Micro Shock was developed as a higher-volume, lightweight, constant-travel shock to fit on most road/oval 1:10 and 1:12 cars, and provides consistently smooth, superior dampening without the need for frequent rebuilds.

The VCS™ Micro Shock body is precision-machined from aircraft-quality aluminum, and is externally threaded for convenient spring preload adjustments. Internally, the shock utilizes Associated's exclusive VCS™ volume compensating system, 7075 aluminum shock piston, molded PTFE components, and a precision-ground, case-hardened steel shock shaft which is extremely resistant to bending.

step 8

- 1: Remove the plastic #4473 VC housing from the parts tree.
- 2: Soak the #4473 VC foam with your #5422 shock oil.
- 3: Push the foam into the housing.

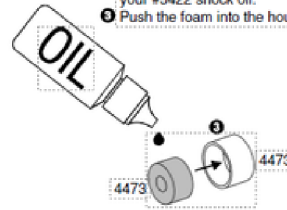

step 9

- 1: Fill #4471 shock body with oil up to the upper groove.
- 2: Insert #4472 shaft/piston all the way to the bottom.



step 10

- 1: Remove the small and large #4473 washers from the parts tree. Remove any flash from the washers.
- 2: Slide the VC housing with foam onto the shaft, housing first (so foam is still seen through the body opening).
- 3: Slide on the following in this order: smaller washer, red O-ring, larger washer, then the star-shaped clip.

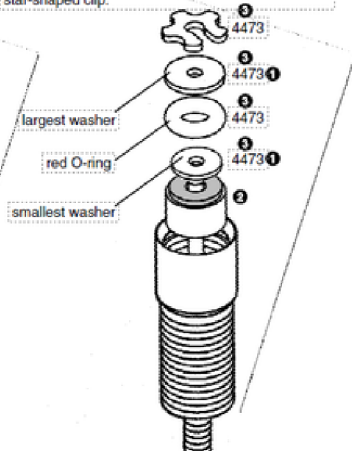

step 11

Use the assembly tool to push all the parts down into the body until the clip snaps into the groove. When you remove the tool, the shaft will push out somewhat if everything snapped into place correctly. Make sure the clip snaps into the groove completely.

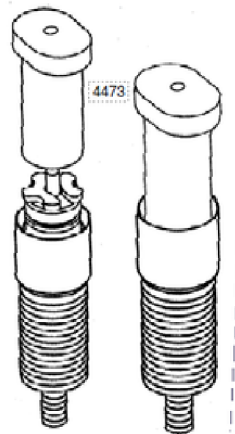

Side Shocks

Use 1 Long RPM Ball Cup & 1 Regular RPM Ball Cup for correct length



E-CLIP, PISTON, E-CLIP

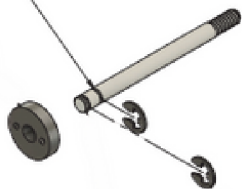

INSTALL COMPLETE SHOCK SHAFT ASSEMBLY INTO SHOCK BODY



ADD A COUPLE DROPS OF SHOCK OIL ON O-RINGS

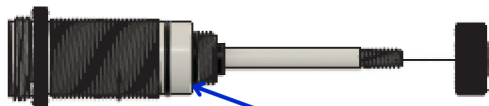
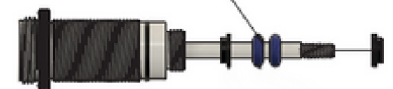

O-ring



Center Shock

Use 2 Regular RPM Ball Cups
Adjust Center Shock for 1.5-2.0mm
Pod Droop (Backtravel)

Front End Assembly

Tsunami and OW Right Front

Both Front ends assemble the same

Use Short Upper Arm and Short Caster Block
Polish King Pin for Smooth Movement (Important)

Kit comes with .018" Front Springs

Use shims under the spring buckets for fine tuning
of front droop

Shim under arm for ride height
(Kit comes with .060" Shims)

TIP - If upper turnbuckle is loose in the arm
use some teflon tape to make it tight



Below pivot ball

Spring Bucket
Spring
Spring Bucket
Shims (.040") start
E-Clip

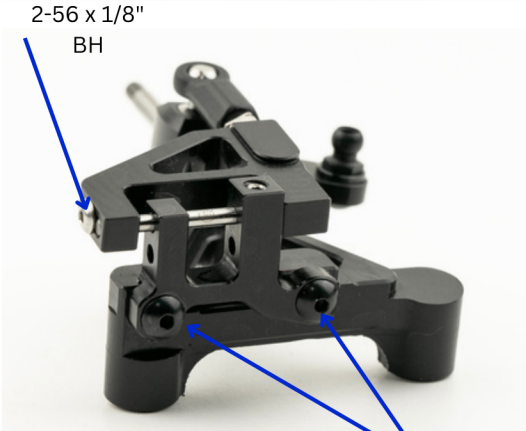

2-56 x 1/8"
BH

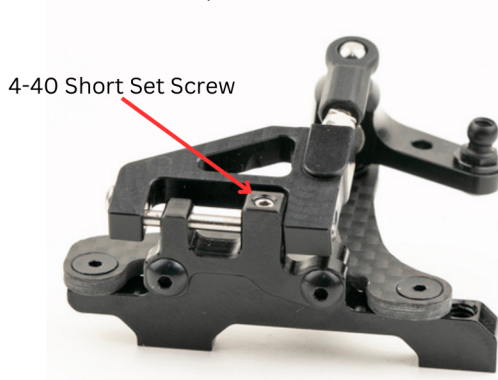

4-40 Short Set Screw

Short OW Ball Stud
4-40 x 1/4" BH
Shim for bump Steer



4-40 x 1/4"
BH



2-56 x 1/8"
BH

Tsunami and OW Left Front

Both Front ends assemble the same

Use Long Upper Arm and Long Caster Block
Polish King Pin for Smooth Movement (Important)

Kit comes with .018" Front Springs

Use shims under the spring buckets for fine tuning
of front droop

Shim under arm for ride height
(Kit comes with .060" Shims)

TIP - If upper turnbuckle is loose in the arm
use some teflon tape to make it tight



4-40 x 3/8"
BH



4-40 Short Set Screw